

ACCENT DIGITAL

RANURA Collection

R6 & M3

RANURA COLLECTION PRODUCTS

R6

6mm wide grooves
and 11 mm deep.

CREATING A SLAT EFFECT.

M3

3mm wide grooves
and 3mm deep.

CREATING A PLANK EFFECT.

For more details on available products, visit accentdigital.ca

Panel standard dimensions : 23 5/8"x96" (600mmx2440mm) or 23 5/8"x120" (600mmx3050mm).

R 6-24 - Walnut on black



LINEAR R6 MODELS



R 6-19



R 6-24

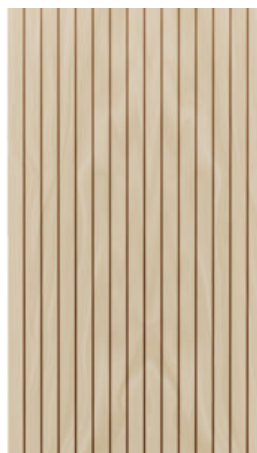

R 6-34

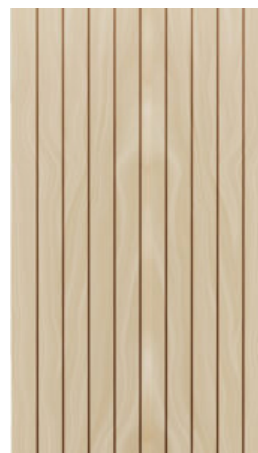

R 6-54

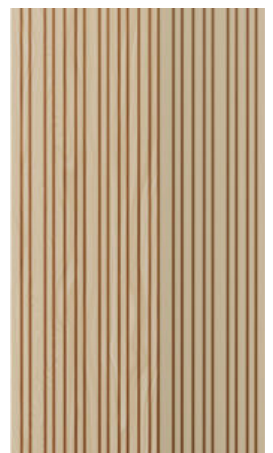

R-RYTHM

Other models available on our website. Possibility of custom patterns.

M3-57 - Varnished oak on black



LINEAR M3 MODELS



M 3-27



M 3-37



M 3-37-74



M 3-57



M 3-27-27-57



M 3-114

Other models available on our website. Possibility of custom patterns.



Chevron 1

Chevron 2

Chevron 3

**R6 DESIGN
MODELS**

R6 - Fusion 1 & Fusion 2 - Varnished maple
Photo : DR. Meunier's Clinic / Design by MAD Design

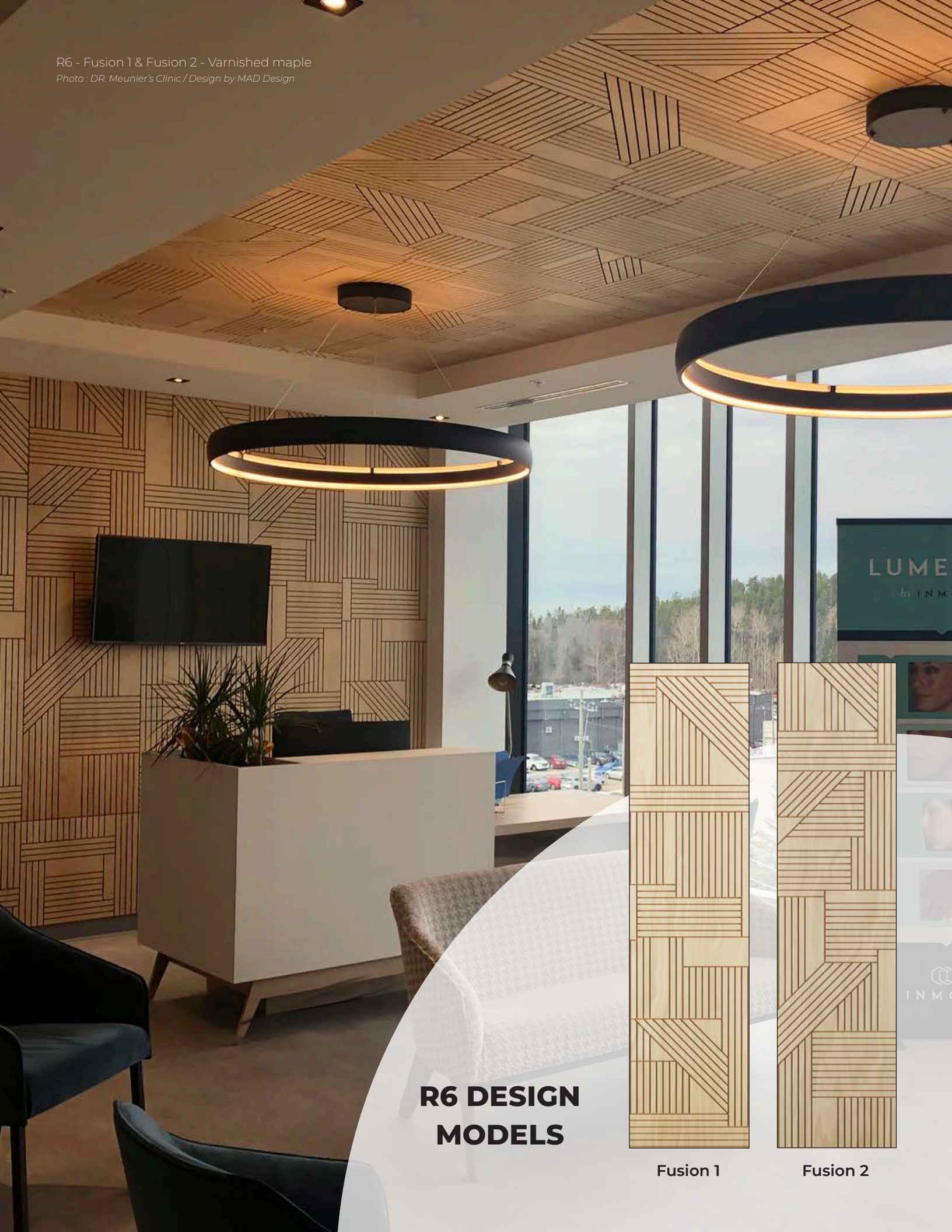

R6 DESIGN MODELS



Fusion 1

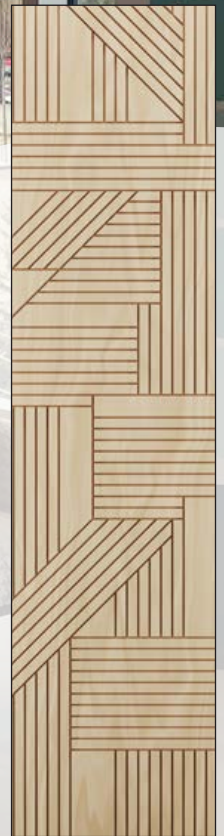

Fusion 2



M3 DESIGN MODELS



Art deco 1



Art deco 2



Art deco 3



Leaves 1



Leaves 2



M3 DESIGN MODELS



Circle



Hexa



Hexagon



Frame



Vine

WOOD SPECIES AND FINISHES

We offer a wide variety of natural wood species and stains, ranging from elegance and sobriety to innovation and boldness. We can design custom dyes and do color matching.

CHOICE OF NATURAL OR BLACK GROOVES

The grooves of all wood veneer and laminate finishes (except walnut and black on black) are standard natural color. As an option, it is possible to ask for black grooves (additional fees to be expected).

Wood Veneers



WHITE OAK



MAPLE



WHITE ASH



BIRCH



WALNUT

Stains



CAMEL



SAHARA



TAUPE



ESPRESSO

Solid color

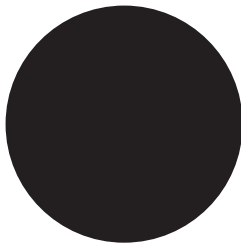

BLACK ON BLACK

Custom color paint available upon on request

Laminate*



URBAN MAPLE



GRAY WALNUT

We offer a wide choice of **laminates** to finish the top of the panels including those from **Tafisa**, **Formica** and **Nevamar**. Possibility of using **other brands of laminates** if necessary. Contact us for more information.

* Only available for the Ranura R-6 linear models



FAST AND SIMPLE INSTALLATION

The manufacturing techniques used by Accent Digital ensure straight and rigid panels, which makes installation easier. Ranura panels can easily be cut and perforated.

INSTALLATION METHOD : R6

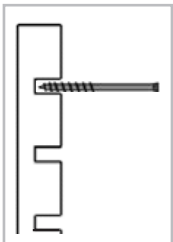

Wall and ceiling

- Narrow head screws
- The screw is located at the bottom of the groove, so it is barely visible. The screws can be supplied by Accent Digital.

Installation alternatives for walls

- Glue and finishing nails
- “Z” suspension bars (Z clip).

INSTALLATION METHOD : M3

Wall and ceiling

- Glue and finishing nails
- Easy installation using a pressure nailer and 23 gauge nails at the grooves.

Alternatives d’installation pour les murs

- “Z” suspension bars (Z clips).

Flame spread rating (FSR)

- Slats CAN/ULC S102 — Class 3 / ASTM E84 — Class C — 150 and below.
Also available — CAN/ULC S102-Class 1 / ASTM E84-Class A — 25 and below.
- The thickness of the finition surface is generally less than 1mm.
Also available — CAN/ULC S102 — Class 1 / ASTM E84 — Classe A — 25 and below.



LOCAL & ECO-RESPONSIBLE BUSINESS

A LOCAL BUSINESS

Accent Digital is the specialist in finishing panels. We aim for excellence and offer products that stand out for their originality and durability. High product uniformity is achieved using state-of-the-art equipment.

FSC CERTIFICATION

All the wood raw materials Accent Digital uses to manufacture its panels are FSC® certified. FSC® certification indicates that forest products come from sustainably and responsibly managed forests. The FSC® seal is a global reference which allows, among other things, the provenance of wood to be traced back to its source

ECO-RESPONSIBLE APPROACH

The panels used in the manufacture of Accent Digital products are made from 100% recycled and pre-consumer recovered wood fibers. In addition, the finishing products used are solvent-free. Accent Digital manufactures premium quality products using an eco-responsible approach.



1-877-531-1001
info@accentdigital.ca
accentdigital.ca

1325, JA Bombardier St., Suite 104
Levis, Quebec
G7A 2P4
Canada

